

# Ditty Bags

## Sizes:

### Personal Ditty Bags

19 in. x 13 in.  
12 in. x 10 in.  
12 in. x 8 in.

Follow all directions as written

### Paddle Bag

your paddle size + 4 1/2 in. x 10 1/2 in.

Follow all directions as written EXCEPT:

- Make folds and stitches in steps 2 & 3 along one of the short sides instead of one of the long sides

### Guide bag Ditty Bags (for side pockets, 2/pack)

19 in. x 14 in.

Follow all directions as written EXCEPT:

- on the "extra step" make stitch on bottom side corners 1 in. up from bottom of corner
- Make folds and stitches in steps 2 & 3 along one of the short sides instead of one of the long sides

### Red pack Ditty Bags (for side pockets, 4/pack)

15 in. x 18 in.

Follow all directions as written EXCEPT:

- on the "extra step" make stitch on bottom side corners 1 1/4 in. up from bottom of corner

## Directions:

Hint: If folds are ironed or pinned sewing will be easier and more exact

### Key:

Inside of fabric

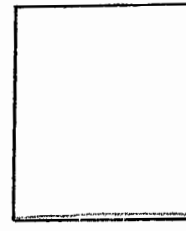

Outside of fabric

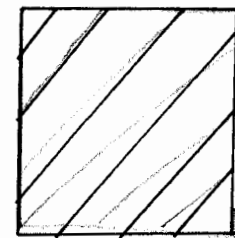

### Step 1:

Cut fabric  
(examples)

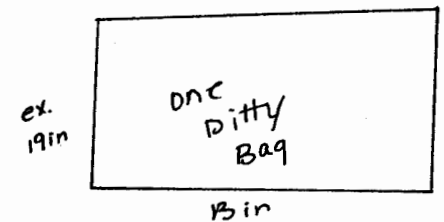
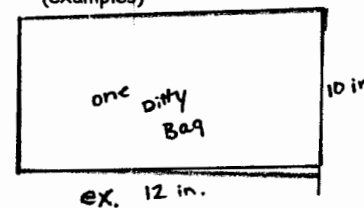

(Measurements following are examples)

### Step 2:

- Lay material horizontally with inside of material facing up.
- Fold top 2 corners in 1 1/2 in. in
- Stitch down folded corners

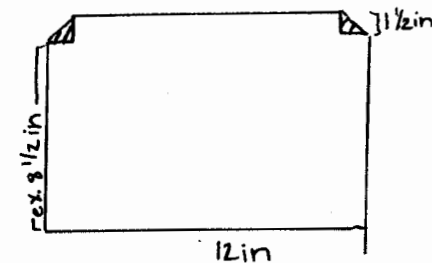
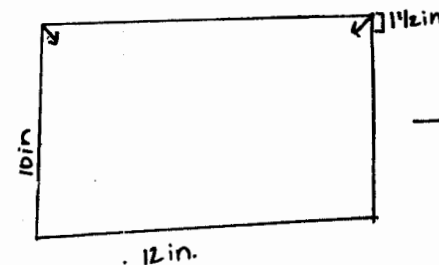

### Step 3:

- take top and fold down to meet bottom stitch of previous fold/stitch
- make a straight stitch all the way across about 1/4 in. from edge of fabric

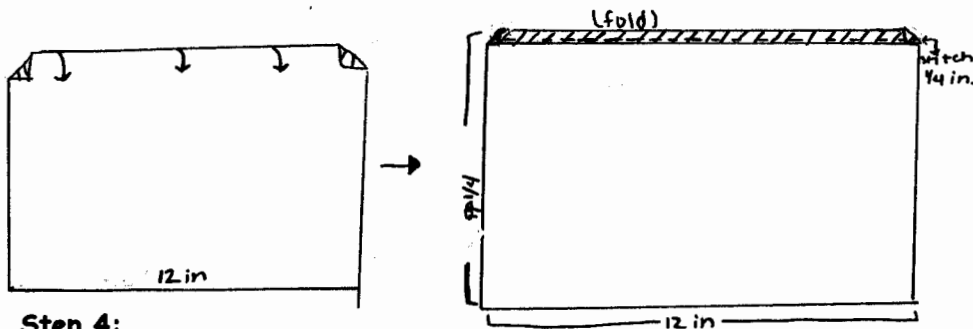

### Step 4:

- Fold all material in half and make a stitch down and across about 1/4 in. from edge of fabric
- \* Keep inside of fabric out

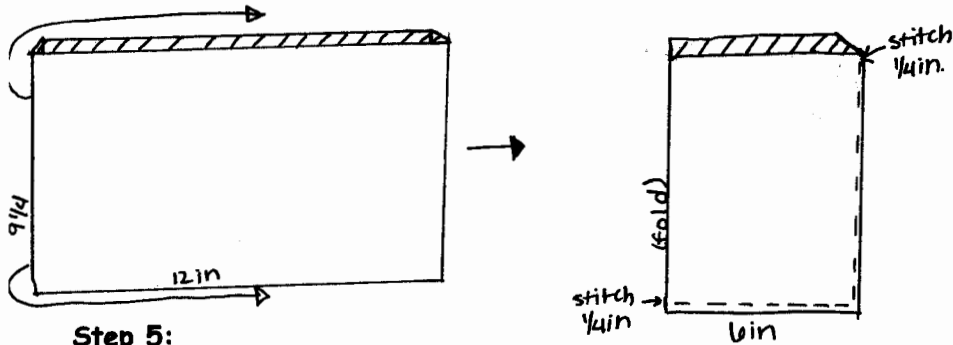

### Step 5:

- Take bag and fold inside out

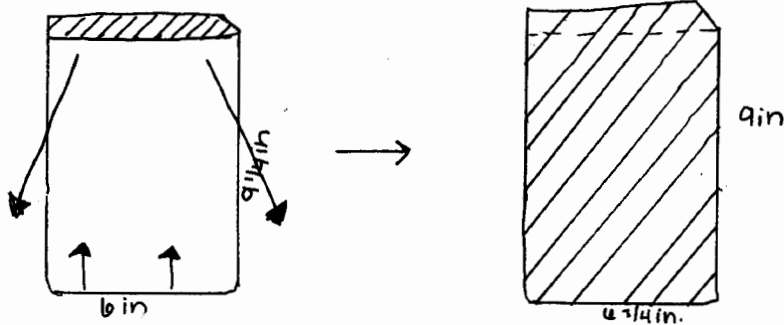

### Step 6:

- add string through top inlet

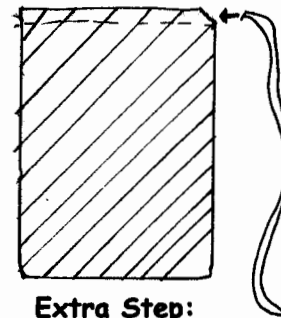

### Extra Step:

- \* An additional step can be added for personal ditty bags, will be added for all pack ditty bags, and won't be added for paddle bag.
- \* This step comes after step 4
- \* Makes bags more box like instead of flat

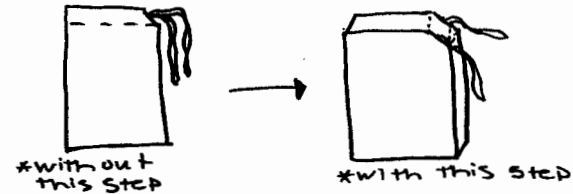

- Take material from step 4
- stitch across bottom corners horizontally with sides of bag facing up
- \* the further up the stitch is made the wider the bag

